

NOTE:
ANY ASPHALT DAMAGED IN THE
REMOVAL NEEDS TO BE REPAIRED
AND THE DITCH BE RE-GRADED
AND SODDED

HORIZON ROAD. (F.M. 3097)

(100' PUBLIC R.O.W.)

ASPHALT

RALPH HALL PARKWAY
(60' PUBLIC R.O.W.)
CONCRETE

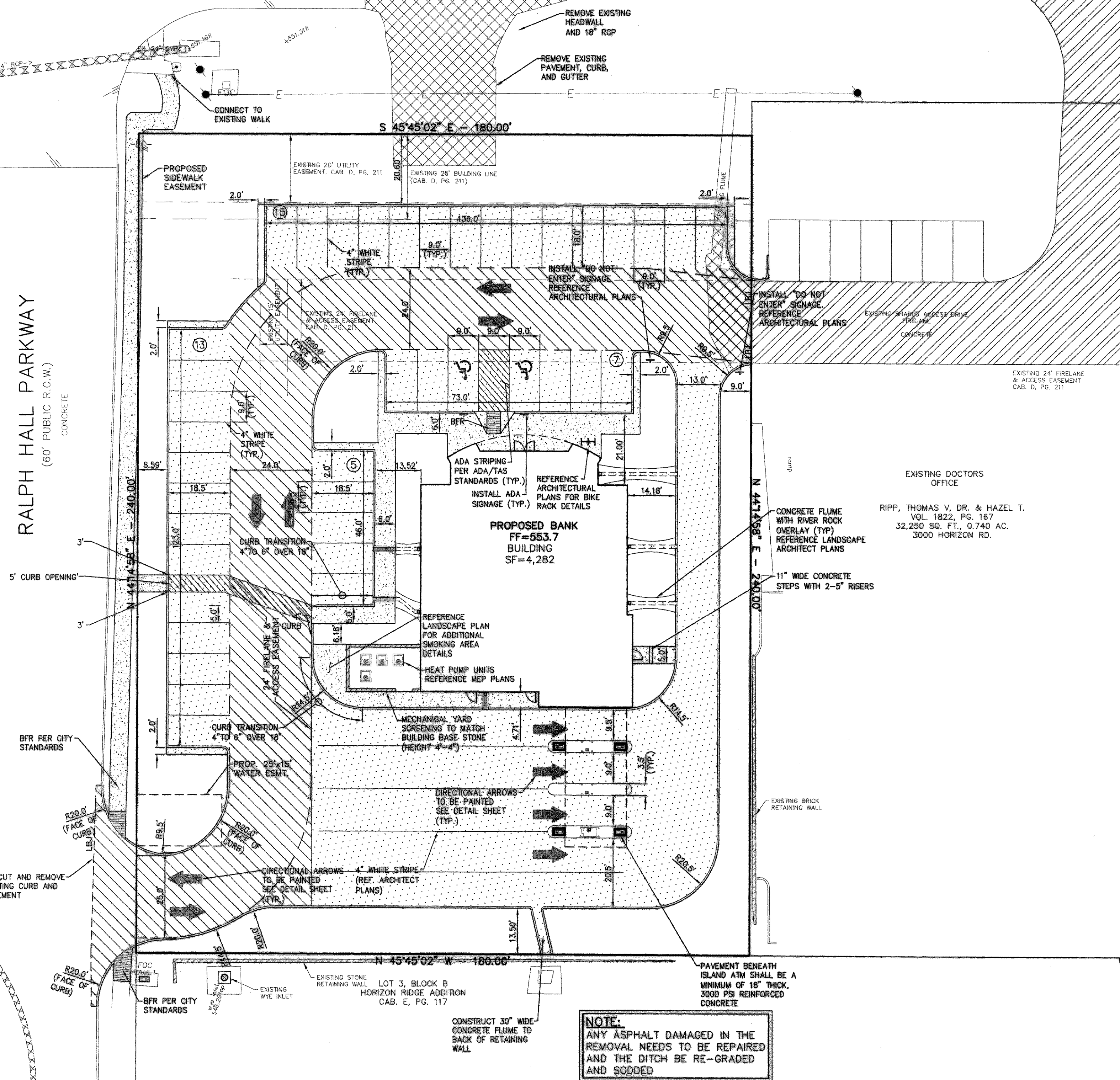

LEGEND

- EXISTING CURB
- PROPOSED CURB
- PROPOSED SAWCUT
- LBJ - CONSTRUCT LONGITUDINAL BUTT JOINT
- BFR - CONSTRUCT BARRIER FREE RAMP
- 6 - PROPOSED PARKING SPACES IN A ROW
- 4" 3000 PSI REINFORCED CONCRETE - PAVEMENT. REFERENCE ARCHITECT LANDSCAPE PLANS FOR ADDITIONAL INFORMATION. (SIDEWALK)
- 5" 3600 PSI REINFORCED CONCRETE ON 6" SCARIFIED AND COMPACTED SUBGRADE (LIGHT DUTY PAVEMENT)
- 6" 3600 PSI REINFORCED CONCRETE ON 6" SCARIFIED AND COMPACTED SUBGRADE (6 SACK MIN FOR MACHINE PLACE AND 6.5 SACK MIN FOR HAND PLACE) (HEAVY DUTY PAVEMENT)
- EXISTING PAVEMENT TO BE REMOVED

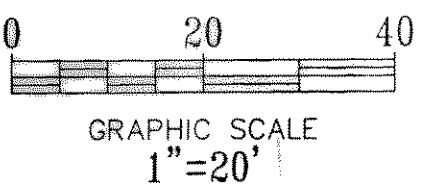

GENERAL NOTES:

- ALL MATERIALS AND CONSTRUCTION WITHIN STREET RIGHT-OF-WAY SHALL CONFORM TO THE CITY STANDARD CONSTRUCTION DETAILS AND SPECIFICATIONS AND NCTCOG 3RD EDITION STANDARDS.
- IT SHALL BE THE RESPONSIBILITY OF THE CONTRACTOR TO PROTECT ALL PUBLIC UTILITIES IN THE CONSTRUCTION OF THIS PROJECT. ALL MANHOLES, CLEANOUTS, VALVE BOXES, FIRE HYDRANTS, ETC. MUST BE ADJUSTED TO PROPER LINE AND GRADE BY THE CONTRACTOR PRIOR TO AND AFTER THE PLACING OF PERMANENT PAVING. UTILITIES MUST BE MAINTAINED TO PROPER LINE AND GRADE DURING CONSTRUCTION OF THIS PROJECT.
- THE CONTRACTOR SHALL BE RESPONSIBLE FOR COORDINATING WITH ALL APPROPRIATE UTILITY COMPANIES FOR THE LOCATION OF ALL UTILITIES WITHIN THE CONSTRUCTION AREA.
- THE PAVING CONTRACTOR SHALL NOT PLACE PERMANENT PAVEMENT UNTIL ALL SLEEVING FOR IRRIGATION, ELECTRIC GAS, TELEPHONE, CABLE TV, SITE IRRIGATION WATER LINES, ETC. HAVE BEEN TESTED AND PASSED. IT SHALL BE THE PAVING CONTRACTOR'S RESPONSIBILITY TO INSURE THAT ALL SLEEVING IS IN PLACE PRIOR TO PLACING OF PERMANENT PAVING.
- ALL PAVING AND EARTHWORK OPERATIONS SHALL CONFORM TO THE RECOMMENDATIONS IN THE GEOTECHNICAL INVESTIGATION REPORT.
- ALL DIMENSIONS ARE FROM BACK OF CURB, EDGE OF PAVEMENT, OR FACE OF BUILDING UNLESS OTHERWISE NOTED.
- ALL SIDEWALKS SHALL MAINTAIN A 2% MAXIMUM CROSS SLOPE AND 5% MAXIMUM IN THE DIRECTION OF PEDESTRIAN TRAVEL.
- SLOPE WITHIN THE HANDICAP PARKING AREA SHALL NOT EXCEED 2% IN ANY DIRECTION.
- CONTRACTOR TO MATCH EXISTING JOINTS WITH JOINTS IN NEW PAVING WHERE THEY ABUT IN LEFT TURN LANE ADDITION.
- PARKING AND HANDICAP STRIPING TO BE PER ADA/TAS STANDARDS. ALSO REFERENCE SPECIFICATIONS FOR MORE DETAILS.
- ALL CURB RADII ARE 1.5' UNLESS OTHERWISE SPECIFIED (EXCEPT FOR AT END OF PARKING SPACES AND FLUMES WHERE THE RADII IS 0').
- CONTRACTOR IS RESPONSIBLE FOR ANY ADDITIONAL REQUIRED TRAFFIC CONTROL PLAN(S).
- ALL PUBLIC R.O.W. WORK TO BE COORDINATED WITH CITY ENGINEERING DEPARTMENT.
- THE CONTRACTOR MUST SUBMIT A COPY OF THE CIVIL IMPROVEMENTS CONSTRUCTION CONTRACT(S) WITH A COVER LETTER ITEMIZING THE UNIT QUANTITIES AND UNIT PRICES FOR THE CIVIL CONSTRUCTION WORK IN R.O.W., FIRE LANES, DRAINAGE/UTILITY EASEMENTS, ETC. AND PAY AN APPLICABLE INSPECTION FEE PRIOR TO THE PRE-CONSTRUCTION CONFERENCE.
- NOTE THAT IT IS THE CONTRACTOR'S RESPONSIBILITY TO COORDINATE THE DATE AND TIME OF THE PER-CONSTRUCTION CONFERENCE WHICH WILL BE HELD AT THE CITY.
- ALL BARRIER FREE RAMPS SHALL COMPLY WITH THE CURRENT TDLR, TASS AND ADA REGULATIONS.
- THE CONTRACTOR SHALL PROVIDE, CONSTRUCT AND MAINTAIN BARRICADES AND SIGNS IN ACCORDANCE WITH THE TEXAS MANUAL OF UNIFORM TRAFFIC CONTROL DEVICES.
- REFERENCE LANDSCAPE PLAN FOR TREE REMOVAL/TREE PROTECTION.
- REFERENCE LANDSCAPE PLAN FOR POSSIBLE ADDITIONAL PAVEMENT/SURFACE TREATMENTS.
- REFERENCE ARCHITECTURAL PLAN FOR ADDITIONAL SITE SIGNAGE.
- SAND SHALL NOT BE ALLOWED BELOW PAVEMENT.

BENCHMARK
CITY OF ROCKWALL BENCHMARK #R017, ±250 EAST OF HORIZON
RD IN MEDIAN OF RALPH HALL ROAD.

ELEVATION=549.46'

PAVING PLAN
CHASE BANK-HORIZON & RALPH HALL
CITY OF ROCKWALL
DALLAS COUNTY, TEXAS

O'DONALD
ENGINEERING LLC
1601 E. Lamar Blvd, Suite 210
Arlington, Texas 76011
Phone 817.794.0202
Fax 817.548.8430

DATE
08/25/08
SCALE
1"=20'
JOB NO
0807027
SHEET
C1

AS-BUILT

NOTE:
THESE PLANS HAVE BEEN REVISED
TO CONFORM WITH CONSTRUCTION
RECORDS PROVIDED BY CONTRACTOR.



CAUTION!!!
CALL: TEXAS ONE CALL @
1-800-245-4545
48 HRS PRIOR TO CONSTRUCTION.

!!! CAUTION !!! UNDERGROUND UTILITIES

EXISTING UTILITIES AND UNDERGROUND FACILITIES INDICATED ON THESE PLANS HAVE BEEN LOCATED FROM REFERENCE INFORMATION SUPPLIED BY VARIOUS OWNERS OF THE FACILITIES. THE ENGINEER DOES NOT ACCEPT THE RESPONSIBILITY FOR THE UTILITY LOCATIONS SHOWN. IT SHALL BE THE RESPONSIBILITY OF THE CONTRACTOR TO VERIFY BOTH HORIZONTALLY AND VERTICALLY THE LOCATION OF ALL EXISTING UTILITIES AND UNDERGROUND FACILITIES PRIOR TO CONSTRUCTION, TO TAKE NECESSARY PRECAUTIONS IN ORDER TO PROTECT ALL FACILITIES ENCOUNTERED, AND TO NOTIFY THE ENGINEER PROMPTLY OF ALL CONFLICTS OF THE WORK WITH EXISTING FACILITIES. THE CONTRACTOR SHALL PRESERVE AND PROTECT ALL EXISTING UTILITIES FROM DAMAGE DURING CONSTRUCTION. ANY DAMAGE BY THE CONTRACTOR TO EXISTING UTILITIES SHALL BE REPAIRED BY THE CONTRACTOR AT HIS OR HER EXPENSE.