

# QUAIL RUN VALLEY NO. 2

## CITY OF ROCKWALL, ROCKWALL COUNTY, TEXAS

### INDEX

ITEM	SHEET
PLAN.....	1-2
PAVING.....	3-13
DRAINAGE.....	14-19
UTILITIES.....	20-21
LOT GRADING.....	22-23
EROSION CONTROL.....	24
TREE SURVEY.....	24A
TREESCPE PLAN.....	24B

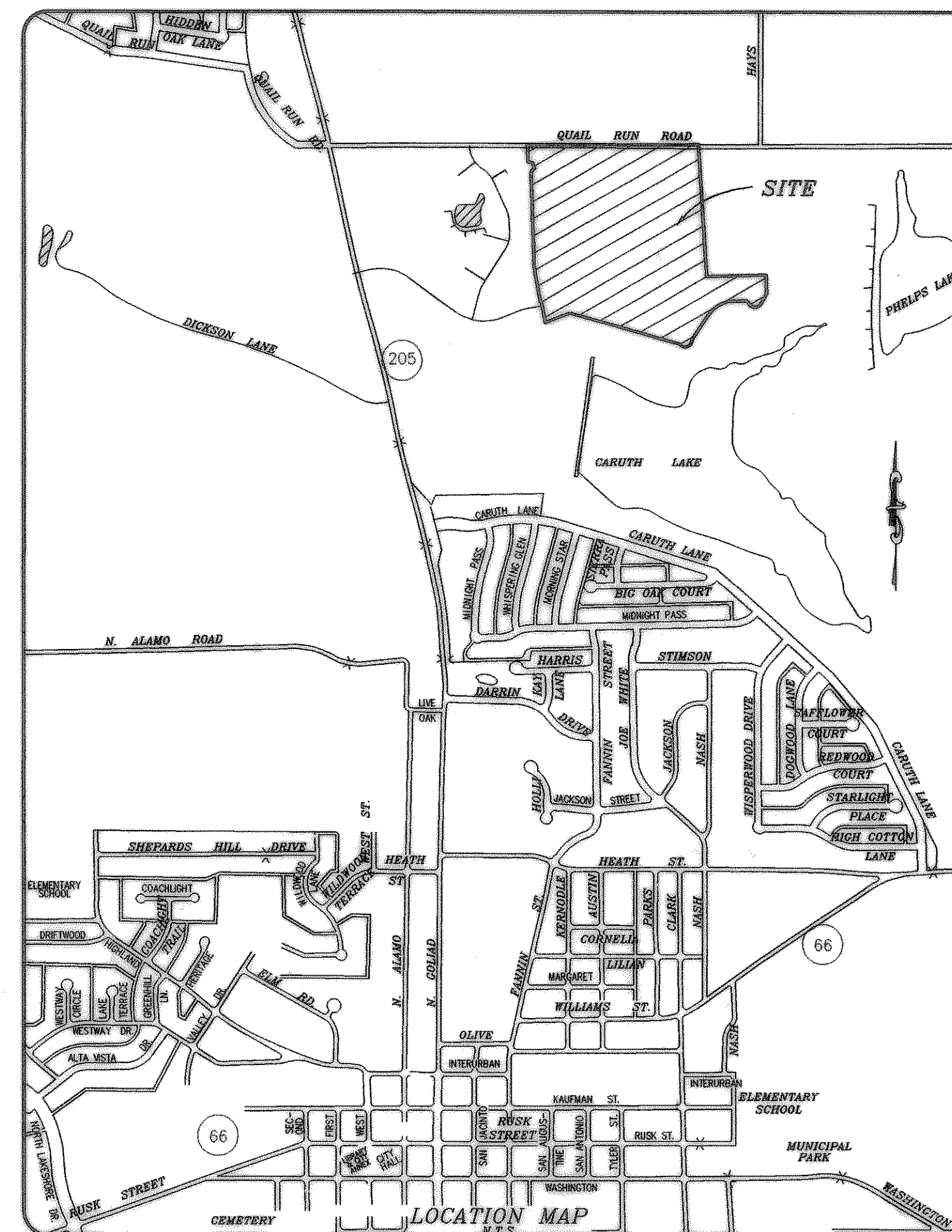
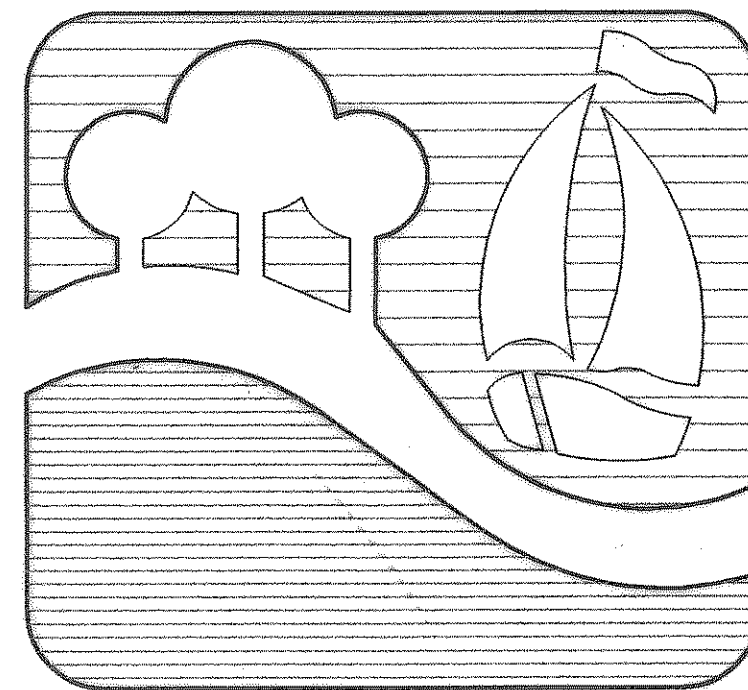

### NTMWD Notes

- North Texas Municipal Water District (NTMWD) 30-inch water transmission pipeline is located within limits of construction.
- Operation of heavy earthmoving equipment, compaction equipment or heavy construction equipment, such as concrete trucks, shall be restricted to specific crossing points across NTMWD easements, as approved by the NTMWD. The crossings shall be designated and verified to provide a minimum of five-feet of cover.
- To assure that placing of significant loads over the NTMWD pipeline does not damage the existing pipeline, no materials shall be stockpiled on the NTMWD easement without authorization from the NTMWD. If the contractor desires to use NTMWD's easement for stockpile of materials, contact NTMWD Engineering at 972/442-5405 so your plans for use NTMWD's easement can be reviewed.
- In areas where the cover between the top of NTMWD pipeline and the bottom of the sub-grade is three (3) feet or less, it is requested that the sub-grade preparation be deleted and a thickened pavement section be used to limit construction activities over the pipeline.
- Crossing of the NTMWD easement with other utilities, such as TV cable, phone, gas, and electric, shall be coordinated with the NTMWD to avoid damage to the NTMWD facilities.
- Outdoor lighting, landscaping screening walls or other facilities shall not be installed in NTMWD easements without written approval of the NTMWD.
- Unless otherwise shown or required, a minimum of one-foot clearance shall be provided for all utilities crossing the NTMWD pipelines.
- Water and sewer lines crossing the NTMWD easement shall be installed in compliance with the Rules and Regulations for Public Water Systems Paragraph 290.44(e), Location of Water Lines.
- The contractor shall contact NTMWD Engineering at 972-442-5405 at least 48 hours prior to performing any work in the vicinity of the NTMWD facilities.

### GENERAL NOTES

- EXCAVATED MATERIAL SHALL BE PLACED AS DIRECTED BY THE OWNER.
- ALL FILL AREAS IN STREET RIGHT - OF - WAYS TO BE DENSITY CONTROLLED AND COMPACTED TO 95% DENSITY AT OPTIMUM MOISTURE CONTENT. FILL AREAS SHALL BE COMPACTED WITH SHEEPS FOOT ROLLER.
- NO TREES SHALL BE CUT EXCEPT ON THE SPECIFIC AUTHORITY OF THE ENGINEER.
- CONSTRUCTION SHALL MEET THE REQUIREMENTS OF THE LATEST REVISION OF THE "STANDARD SPECIFICATIONS FOR CONSTRUCTION", CITY OF ROCKWALL.
- PAVEMENT THICKNESS SHALL BE AS FOLLOWS:
 

RESIDENTIAL STREETS	= 6" THICK, 3600 P.S.I. CONCRETE
MINOR COLLECTOR STREET	= 6" THICK, 3600 P.S.I. CONCRETE
MAJOR COLLECTOR & ARTERIAL STREETS	= 8" THICK, 3600 P.S.I. CONCRETE
CONCRETE MIX SHALL BE MINIMUM 6 SACK WITH MACHINE PLACEMENT AND 6-1/2 SACK WITH HAND PLACEMENT.	
- IT SHALL BE THE RESPONSIBILITY OF THE CONTRACTOR TO LOCATE AND VERIFY ALL EXISTING UTILITIES PRIOR TO THE BEGINNING OF CONSTRUCTION TO INSURE NO CONFLICT BETWEEN ALL UTILITY LINES.
- WHERE WATER PIPELINES EITHER CROSS OR OTHERWISE COME WITHIN 9 FEET OF A SANITARY SEWER PIPELINE THE SEWER PIPELINE SHALL BE EITHER CAST IRON OR PVC PIPE WITH A MINIMUM WORKING PRESSURE CLASS OF 150 PSI.
- ALL WATER SERVICES TO BE 1" INSTALLED TO THE CENTER OF EACH LOT WITH SEWER LATERALS 10" DOWNSTREAM. WATER SERVICES SHALL BE PE 200 PSI SDR 9 WITH METAL INSERTS.
- CONDUITS FOR S. W. BELL AND NORTH TEXAS CABLE COMM T.V. SHALL HAVE 30" OF COVER AND SHALL EXTEND 2 FEET BEYOND FUTURE PAVING.
- ALL FITTINGS SHALL BE BRASS COMPRESSION.
- RESILIENT SEATED GATE VALVES ONLY WILL BE ALLOWED.
- BLUE MARKER E. M. S. #1252 SHALL BE PLACED UNDER EACH CORPORATION STOP
- GREEN MARKER E. M. S. #1253 SHALL BE PLACED UNDER EACH SEWER SERVICE AND AT EACH MANHOLE AT A DEPTH NOT TO EXCEED 5 FEET.
- WATER LINES TO BE MINIMUM CLASS 200 PVC - C900 (6" - 12") AND C905 (LARGER THAN 12")
- EROSION CONTROL SHALL BE PLACED AND INSPECTED PRIOR TO ANY WORK BEING PERFORMED.

### TXU ELECTRIC COMPANY GENERAL NOTES

- CONTRACTOR TO INSTALL ALL CONDUIT AS SHOWN ON PRINT.
- TXU ELECTRIC COMPANY TO FURNISH CONDUIT AND CABLE MARKERS.
- DEVELOPER TO INSTALL 1 (ONE) CABLE MARKER AT EACH END OF CONDUIT.
- EACH CONDUIT MUST BE BURIED A MINIMUM OF 40" DEEP (AFTER LAND IS BROUGHT TO FINAL GRADE AND EXTEND 2 FEET BEYOND FUTURE PAVING).
- EACH CONDUIT MUST BE INSPECTED BY THE DISTRIBUTION DEPARTMENT BEFORE BACKFILLING IN TRENCH. ROBERT GAYLOR 487-2351.
- EACH CONDUIT MUST HAVE A PULL WIRE INSTALLED AND BE CAPPED AT BOTH ENDS.
- TRENCHES WITHIN CITY STREETS AND RIGHTS-OF-WAY SHALL BE COMPACTED TO 95% DENSITY.

OWNER :

CONTINENTAL HOMES OF TEXAS

621 WEST COLLEGE

GRAPEVINE, TEXAS 76051

817-481-7750



11-01

ASBUILT

Winkelmann & Associates, Inc. hereby states that this plan, to the best of our knowledge is "As Built." Modifications from the originally approved construction documents have been made as per information provided by the contractor. Winkelmann & Associates, Inc. does not certify as to the correctness or quality of construction as no field inspection was performed.

9-27-02  
DATE  
Ph 2A only  
9-14-04  
Ph 2B

HAROLD L. EVANS, CONSULTING ENGINEER

P.O. BOX 28355

DALLAS, TEXAS 75228

( 214 ) 328-8133