

# CIVIL CONSTRUCTION PLANS

**OWNER/DEVELOPER:**  
CARLSON RESTAURANTS WORLDWIDE  
4201 MARSH LANE  
CARROLLTON, TEXAS 75007  
(972) 662-4685

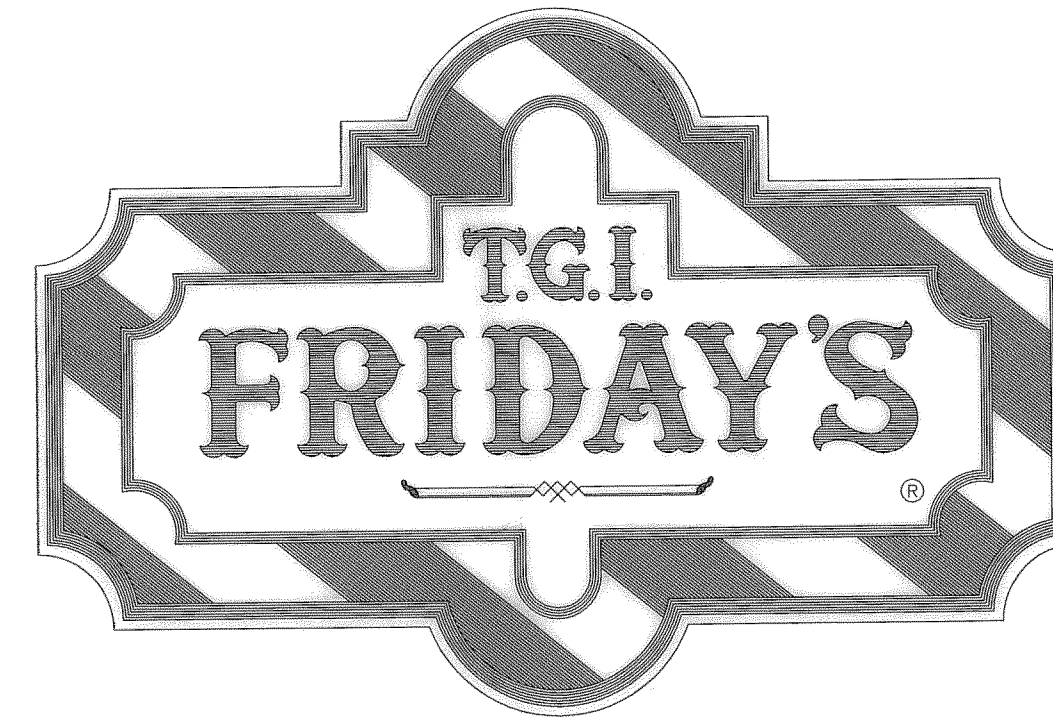

## SHEET INDEX

- 1.0 COVER SHEET
- 2.0 GENERAL NOTES
- 3.0 FINAL PLAT
- 3.1 PLAT VERBAGE
- 4.0 DIMENSIONAL CONTROL PLAN
- 5.0 DRAINAGE AREA MAP
- 6.0 STORM GRADING PLAN
- 7.0 STORM SEWER PLAN
- 7.1 STORM CALCULATIONS
- 7.2 STORM PROFILE
- 8.0 COMPOSITE UTILITY PLAN
- 9.0 SITE/PAVING PLAN
- 9.1 PAVING DETAILS & NOTES
- 10.0 SIGNING/STRIPING PLAN
- 10.1 SIGNING/STRIPING DETAILS & NOTES
- 11.0 EROSION CONTROL PLAN
- 11.1 EROSION CONTROL DETAILS
- 12.0 LANDSCAPE PLAN

## ARCHITECT



Parkway Plaza I  
14110 Dallas Parkway  
Suite 100  
Dallas Texas 75240  
Ph: (972) 239-8884  
Fax: (972) 239-5054

J.D. McFARLAND SURVEY, ABSTRACT NO. 145  
CITY OF ROCKWALL  
ROCKWALL COUNTY, TEXAS  
LOT 3 - 1.41 ACRES

## CIVIL ENGINEER/SURVEYOR

DOUPHRATE & ASSOCIATES, INC.  
ENGINEERING • PROJECT MANAGEMENT • SURVEYING  
P.O. BOX 1336 ROCKWALL, TEXAS 75087  
PHONE: (972)771-9004 FAX: (972)771-9005

## LANDSCAPE ARCHITECT

THP T. H. Pritchett / Associates  
3017 WESTMINISTER DRIVE,  
FARMERS BRANCH, TX 75235  
972-484-7373 FAX 972-484-1230

## GEOTECH

REED ENGINEERING GROUP  
2424 STUTZ DRIVE, SUITE 400  
DALLAS, TX 75235  
(214) 350-5600

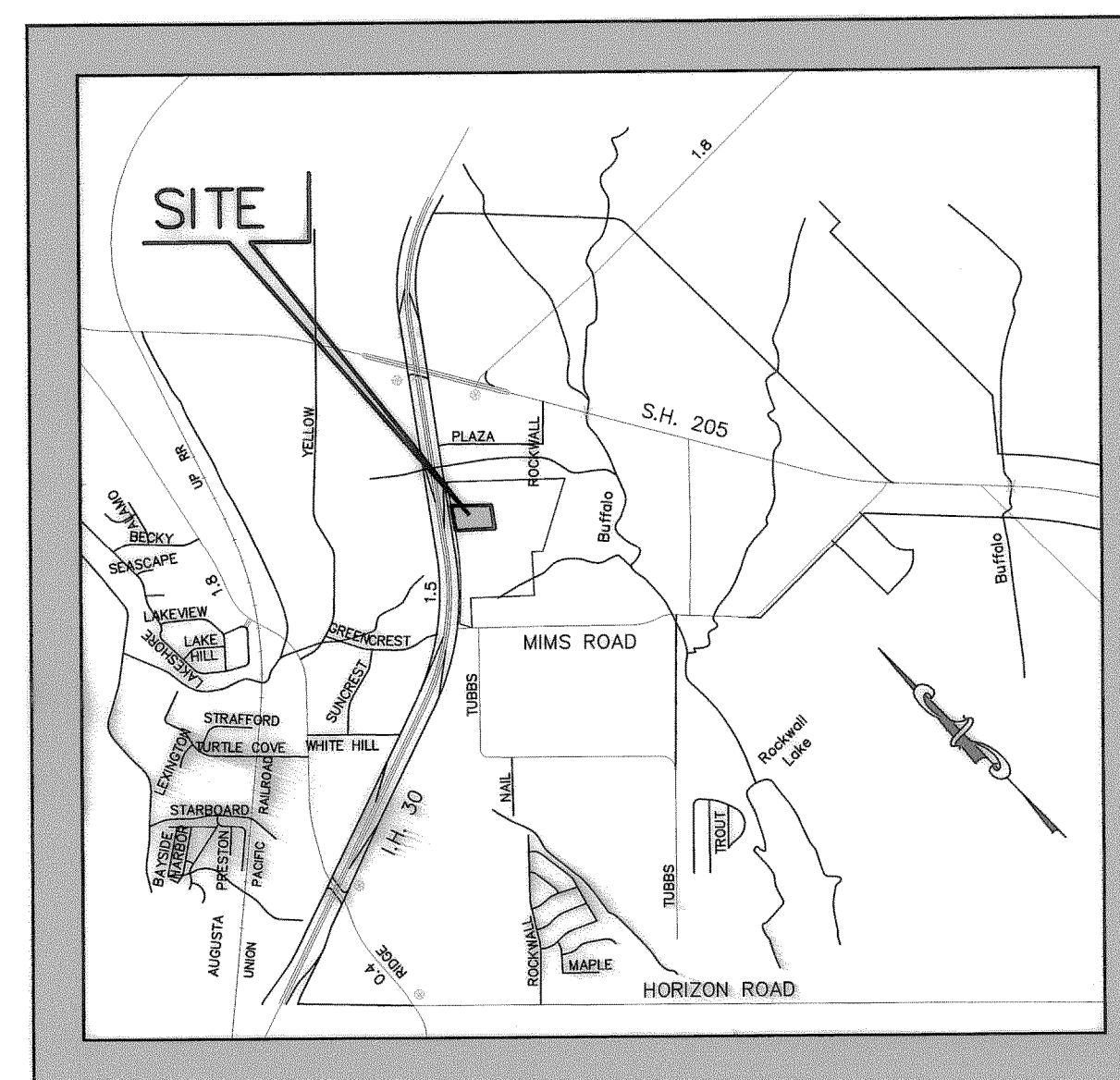

VICINITY MAP

DISCLAIMER:  
THE EXISTING CONDITIONS SHOWN  
ON THESE PLANS ARE DESIGNED  
CONDITIONS FROM OVERALL  
DEVELOPMENT OF ROCKWALL  
CROSSING PROJECT.

**NOTE:**  
CONTRACTOR TO VERIFY IN THE FIELD THE  
LOCATION OF ALL EXISTING UTILITIES PRIOR TO  
CONSTRUCTION. INFORMATION PROVIDED WITHIN  
THESE PLANS DOES NOT RELIEVE THE CONTRACTOR  
OF THE FULL AND TOTAL RESPONSIBILITY FOR THE  
PROTECTION OF EXISTING UTILITIES NOR ANY DAMAGES  
CAUSED BY SAID CONTRACTOR DURING CONSTRUCTION.

GENERAL NOTES  
(APPLICABLE TO ALL SHEETS)

1. ALL WORKS ON THIS PROJECT/CONTRACT SHALL COMPLY WITH ALL THE REQUIREMENT OF CITY OF  
ROCKWALL AND AUTHORITIES HAVING JURISDICTION.

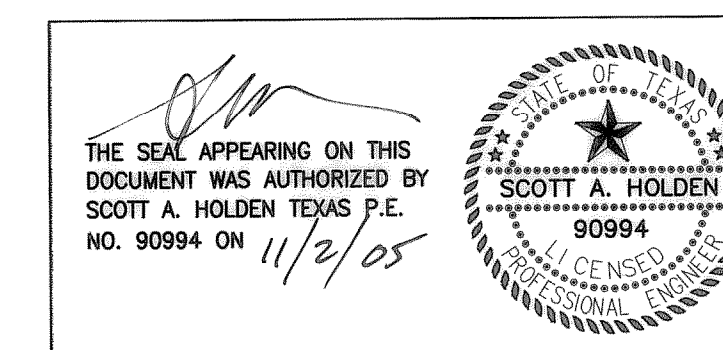

**RECORD DRAWING**  
THIS DRAWING HAS BEEN REVISED TO REFLECT  
CONSTRUCTION RECORDS MAINTAINED AND PROVIDED  
BY THE CONTRACTOR FOR THIS PROJECT.  
DATE: 11-2-05

January 15, 2005