

AS-BUILT

THIS RECORD DRAWING IS COMPILATION OF A COPY OF THE SEALED ENGINEERING DRAWING FOR THIS PROJECT; MODIFIED BY ADDENDA, CHANGE ORDERS, AND INFORMATION FURNISHED BY THE CONTRACTOR. THE INFORMATION SHOWN ON THE RECORD DRAWINGS THAT WAS PROVIDED BY THE CONTRACTOR OR OTHERS NOT ASSOCIATED WITH THE DESIGN ENGINEER CANNOT BE VERIFIED FOR ACCURACY OR COMPLETENESS. THE ORIGINAL SEALED DRAWING ARE ON FILE AT THE OFFICES OF WINKELMANN AND ASSOCIATES, INC.

*Neill Winkelmann*  
WINKELMANN AND ASSOCIATES, INC.

04-20-2026  
DATE

- NOTES:**
1. ALL RESPONSIBILITY FOR ADEQUACY OF DESIGN REMAINS WITH THE DESIGN ENGINEER. THE CITY OF ROCKWALL, IN REVIEWING AND RELEASING PLANS FOR CONSTRUCTION, ASSUMES NO RESPONSIBILITY FOR ADEQUACY OR ACCURACY OF DESIGN.
  2. ALL STORM IS PRIVATE UNLESS NOTED AS PUBLIC

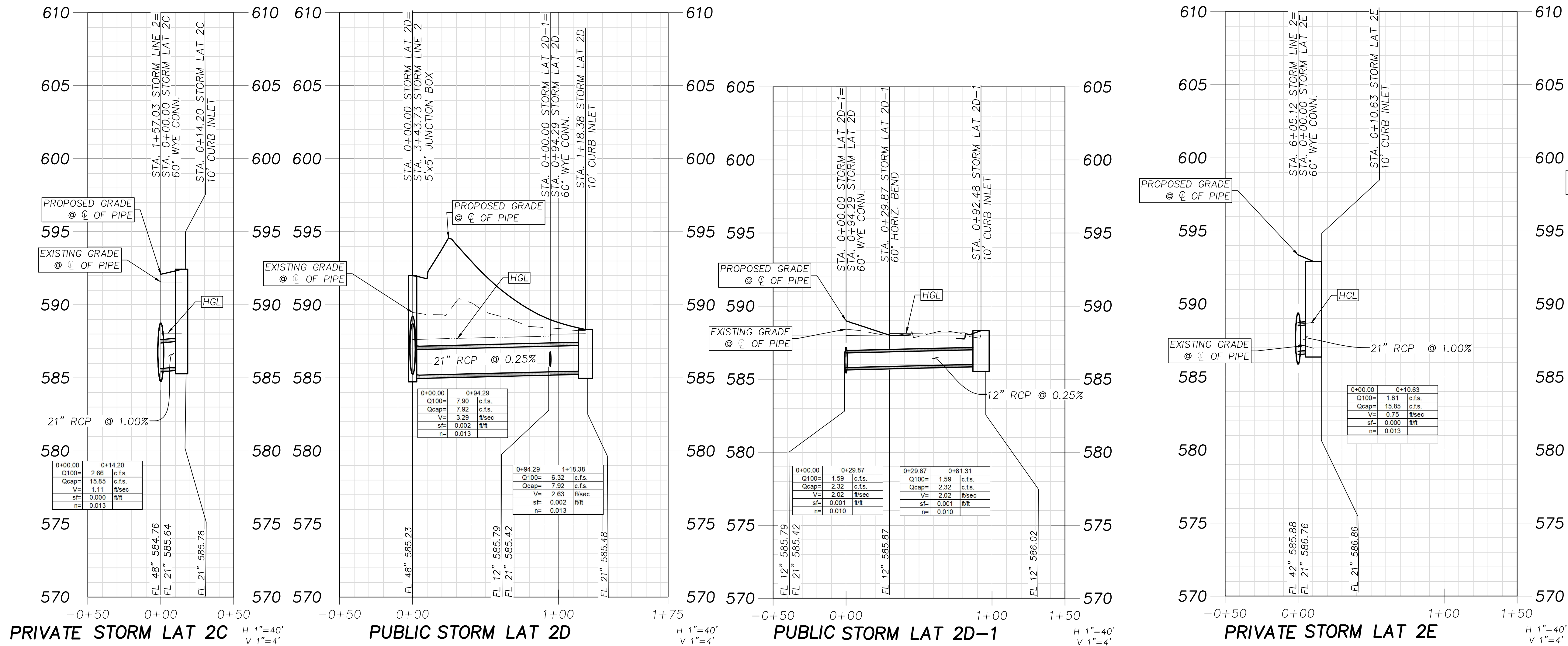

**BENCH MARKS:**

BM#1 - "X" cut on the most Westerly Northwest corner of a curb inlet, West curb line of F.M. Highway 3549, ±18.0 feet East of the East property line of Tract 2 and ±5.1 feet North of the North property line of Tract 2.  
ELEVATION - 605.81 feet

BM#2 - "X" cut on the most Northerly Northwest corner of a curb inlet, West curb line of F.M. Highway 3549, ±81.2 feet East of the East property line of Tract 2 and ±27.3 feet North of the South property line of Tract 2.  
ELEVATION - 593.26 feet

BM#3 - "X" cut on the most Northerly Northwest corner of a curb inlet, North curb line of Interstate Highway 30 (service road), ±10.9 feet South of the South property line and ±33.8 feet Northeast of the most Southerly Southwest corner of Tract 2.  
ELEVATION - 587.31 feet

5.					
4.					
3.					
2.					
1.					
No.					
					APPROV
					REVISION
					DATE
					LAST SAVED BY: C04J05A, Apr 21, 2026

**Winkelmann & Associates, Inc.**  
CONSULTING CIVIL ENGINEERS • SURVEYORS  
6750 HILGREET PLAZA DR., SUITE 215  
ROCKWALL, TEXAS 75087  
(972) 460-7099  
FAX (972) 460-7098  
Professional Registration No. 107866-00  
Professional Engineer Registration No. 107866-00  
Contract # 2426, Williamson & Associates, Inc.

**NEILL WINKELMANN**  
STATE OF TEXAS  
REGISTERED PROFESSIONAL ENGINEER  
NO. 120378  
EXPIRES 02-25-2025  
THE SEAL APPEARING ON THIS DOCUMENT WAS AUTHORIZED BY WILLIAM R. WINKELMANN, P.E. # 120378

**STORM PROFILE 8**  
I-30 FRONTAGE RD & FM 3549  
ROCKWALL, TX  
IKEA @ ROCKWALL HEIGHTS

**C-07.10**