

LOCATION MAP  
MAPSCO PAGE 20C-Z

**CAUTION!!!**  
EXISTING UTILITIES AND UNDERGROUND FACILITIES INDICATED ON THESE PLANS HAVE BEEN LOCATED FROM REFERENCE INFORMATION. IT SHALL BE THE RESPONSIBILITY OF THE CONTRACTOR TO VERIFY BOTH HORIZONTALLY AND VERTICALLY THE LOCATION OF ALL EXISTING UTILITIES AND UNDERGROUND FACILITIES PRIOR TO CONSTRUCTION, TO TAKE NECESSARY PRECAUTIONS IN ORDER TO PROTECT ALL FACILITIES ENCOUNTERED. THE CONTRACTOR SHALL PRESERVE, ADJUST TO MATCH NEW GRADES, AND PROTECT ALL EXISTING UTILITIES FROM DAMAGE DURING CONSTRUCTION.

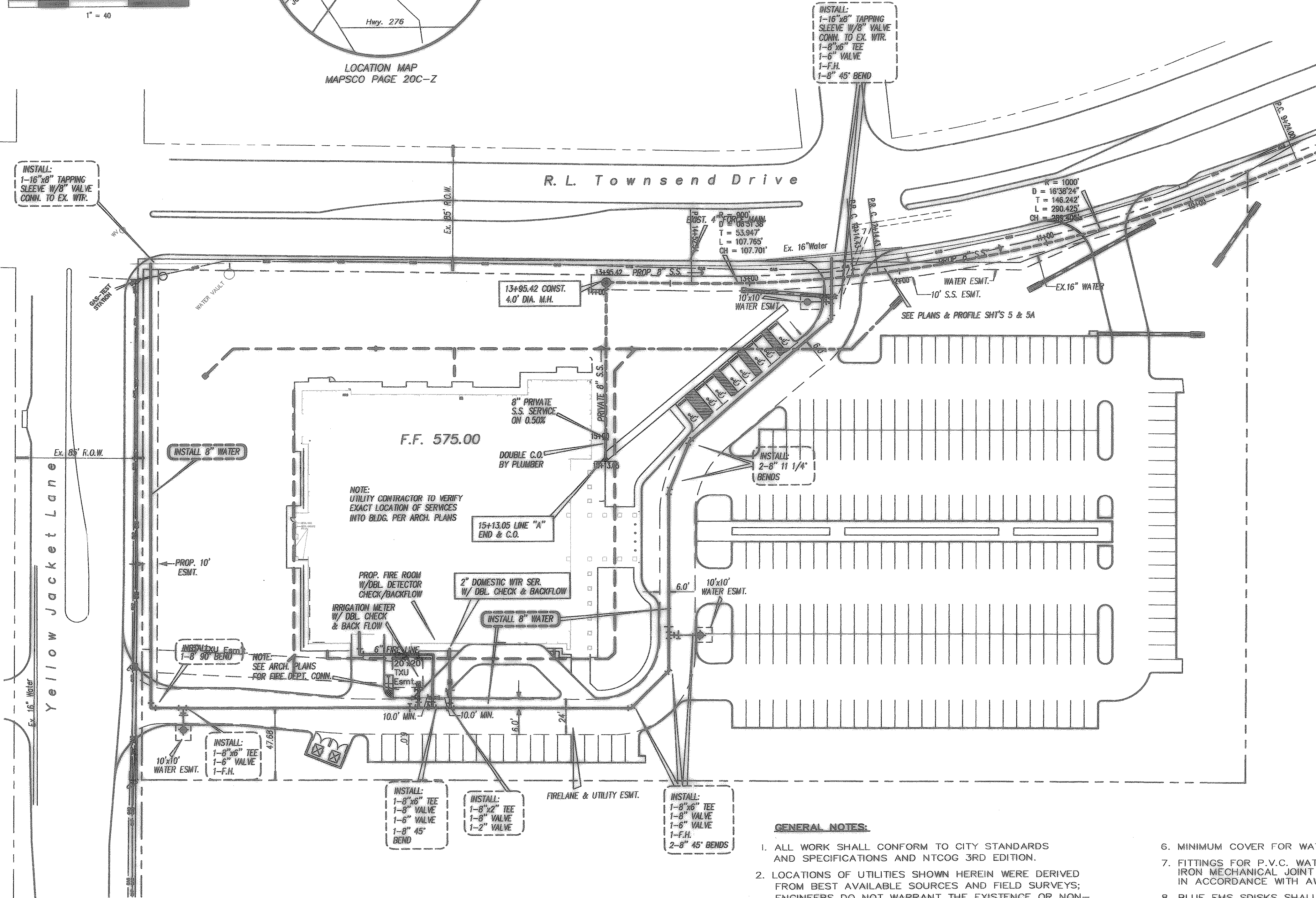

**GENERAL NOTES:**

- ALL WORK SHALL CONFORM TO CITY STANDARDS AND SPECIFICATIONS AND NTCOG 3RD EDITION.
- LOCATIONS OF UTILITIES SHOWN HEREIN WERE DERIVED FROM BEST AVAILABLE SOURCES AND FIELD SURVEYS; ENGINEERS DO NOT WARRANT THE EXISTENCE OR NON-EXISTENCE OF UTILITIES. THE CONTRACTOR SHALL BE RESPONSIBLE FOR DETERMINING THE EXACT LOCATION, DEPTHS AND SIZE OF ALL UNDERGROUND UTILITIES AND STRUCTURES PRIOR TO CONSTRUCTION AND SHALL BE LIABLE FOR ANY DAMAGES OR DOWN-TIME CAUSED BY FAILURE TO COMPLY WITH THESE INSTRUCTIONS.
- WATER AND SANITARY SEWER CALLOUTS (LIST OF FITTINGS) ARE GENERAL. ALL FITTINGS AND ADJUSTMENTS NECESSARY FOR INSTALLATION OF PROPOSED UTILITIES, SHALL BE INSTALLED AND MADE BY THE CONTRACTOR, AND COORDINATE WITH OTHER UTILITIES AS PART OF THIS PROJECT.
- SANITARY SEWER P.V.C. SHALL BE SDR 26 or SDR 35.
- ALL WATER MAIN P.V.C. SHALL BE CLASS C-200 (PRESSURE PIPE) AWWA C-900 (DR-14 or DR-18).

- MINIMUM COVER FOR WATER MAIN SHALL BE 48 INCHES.
- FITTINGS FOR P.V.C. WATER PIPE SHALL BE DUCTILE IRON MECHANICAL JOINT AND SHALL BE CLASS 200 IN ACCORDANCE WITH AWWA C110-77 (ANSI A21.10).
- BLUE EMS DISKS SHALL BE INSTALLED ON THE WATER LINE AT EVERY CHANGE IN DIRECTION, VALVE, AND SERVICE.
- GREEN EMS DISKS SHALL BE INSTALLED ON THE SANITARY SEWER LINE AT EVERY CHANGE IN DIRECTION, MANHOLE, CLEANOUT, AND SERVICE.

WATER AND SANITARY  
SEWER PLAN  
Rockwall Library

F.C. CUNY CORPORATION

#2 Horizon Court  
Heath, Texas 75032  
Phone: 469-402-7700  
Fax: 469-402-0700

THE SEAL APPEARING ON THIS DOCUMENT WAS AUTHORIZED BY CHRISTOPHER R. CUNY, P.E. 65642

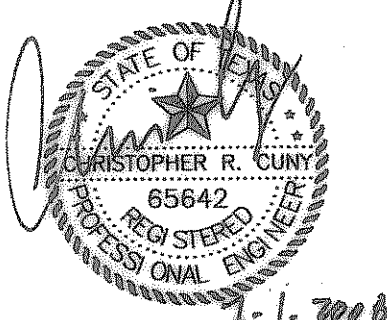

Drawn By: MSC  
Checked By: D/W  
Date: 6-22-07  
Project No.: 05-017

Water and Sanitary  
Sewer Plan

Scale: 1"=40'  
Sheet No.: 4 of 11

CONSTRUCTION RECORD DRAWINGS  
JULY 2008